

# Product End of Life Instructions

**Modicon M580 ePAC controller**

**Modicon M580**



## ⚠ End of Life Instructions

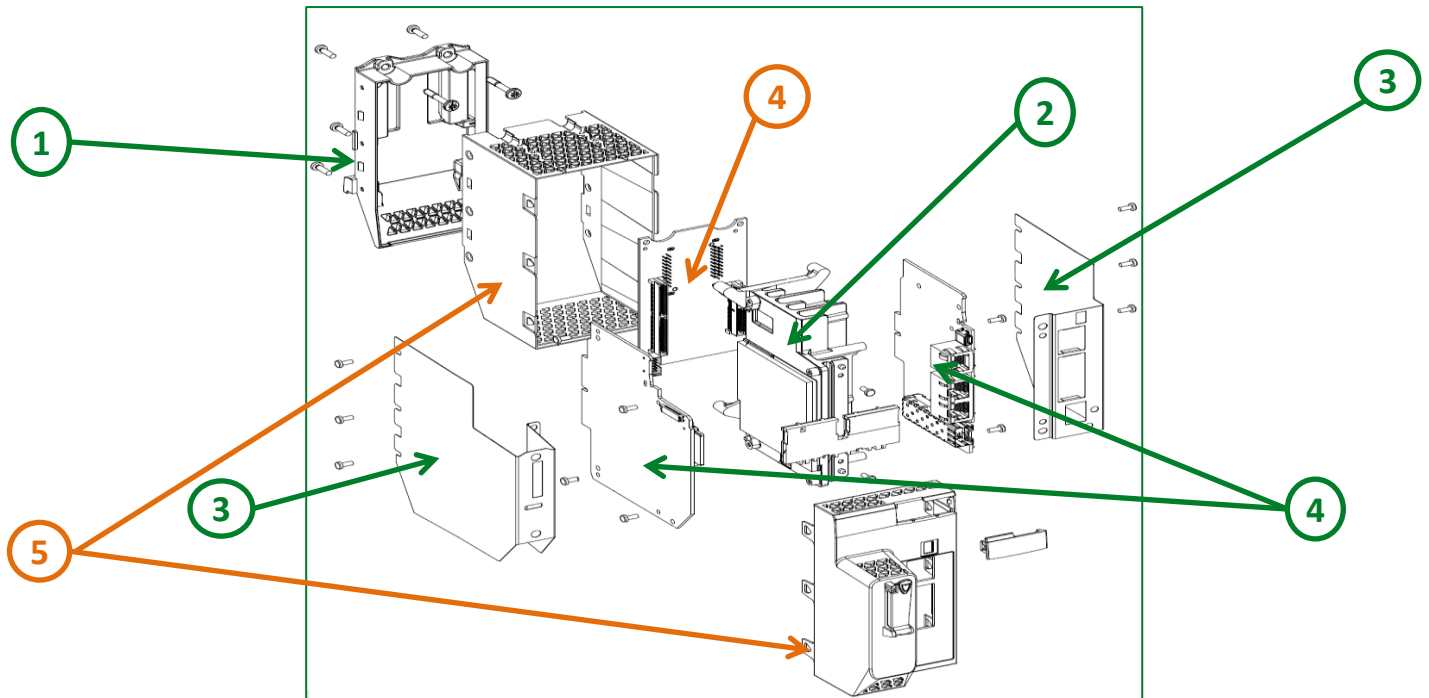

Recommendation	Number on drawing	Component / Material	Weight (in g)	Comment
To be dismantled	1	Zamak	164	
To be dismantled	2	Aluminium	228	
To be dismantled	3	Stainless steel	69	
To be depolluted	4	Electronic Board (Communication) > 10cm <sup>2</sup>	170	
To be depolluted		Electronic Board (Power) > 10cm <sup>2</sup>		
To be depolluted	5	PC, ABS-PC, PA, PA6, HDPE, SAN with brominated flame retardants	164	

## 📄 Product description

Manufacturer identification	Schneider Electric Industries SAS
Brand name	Schneider Electric
Product function	The Modicon M580 ePAC is the first high-end integrated controller CPU built for EcoStruxure™ Plant in an open, flexible, reliable, sustainable, safe, and secure architecture. It features redundant controllers and safety controllers (safety PLC SIL3) with native Ethernet, and cybersecurity embedded in its core. Modicon M580 is high-end CPU for Hybrid Automation Systems.
Product reference	BMEP582040
Total representative product mass	795 g
Representative product dimensions	64mm x 132mm x 130mm
Date of information release	12/2022

## Additional information

### Legal information

This product family is in the scope of European Union directive 2012/19/EU on Waste Electrical and Electronic Equipment (WEEE). The product family must be disposed according to the legislation of the country. This document is intended for use by end of life recyclers or treatment facilities. It provides the basic information to assure an appropriate end of life treatment for the components and materials of the product.

### Recyclability potential

**68%**

Based on “ECO'DEEE recyclability and recoverability calculation method” (version V1, 20 Sep. 2008 presented to the French Agency for Environment and Energy Management:

Schneider Electric Industries SAS

Country Customer Care Center  
<http://www.schneider-electric.com/contact>

35, rue Joseph Monier  
 CS 30323

F- 92506 Rueil Malmaison Cedex

RCS Nanterre 954 503 439  
 Capital social 896 313 776 €

[www.schneider-electric.com](http://www.schneider-electric.com)

ENVEOLI1312016\_V4

Published by Schneider Electric

© 2019 - Schneider Electric – All rights reserved

12/2022