

Basic control actuator



3476

Description

The device is part of the Basic automation system, and is therefore characterized by a compact size, which makes it possible for it to be installed inside flush mounted boxes, junction boxes, other boxes and trunking. Particularly suitable is the installation inside junction boxes, positioning the item at the back of the flush mounted box, behind lowered automation devices, or behind traditional type devices (pushbuttons, switches, etc.). This actuator/ control accepts on the input a traditional pushbutton with NO contact. The control/actuation device has a BUS inlet made by means of the blue cables, an inlet to connect the external pushbutton by means of the grey and black cables and a relay contact to control the load by means of the two white cords.

Technical data

Power supply from BUS:	27 Vdc
Operating power supply with SCS BUS:	18 – 27 Vdc
Absorption:	13 mA
Power/Absorption of driven loads:	

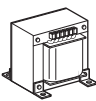
	Incandescent lamps Halogen lamp	LED lamp Compact fluorescent lamp	Ferromagnetic transformers
			
230 Vac	460 W	2 A	40 W
		Max. 1 lamp	2 A cosφ 0.5
			460 VA

Size: basic module

Configuration

The actuator performs all the basic operating modes that can be configured directly on the control, apart from those which require the use of two interlocked relays. Moreover further operating modes with the configurator in position M of the same actuator are listed in the table below.

Possible function	Configurator in M
Cyclical ON/OFF	No configurator
ON/OFF mode	0/1
Pushbutton (On monostable) ignores Room and General controls	PUL
Actuator as Slave. Receives a control sent by a Master actuator with the same address	SLA
Timed ON ¹⁾	1 – 8 ¹⁾

1) If controlled by external pushbutton the device switches OFF after a time set by the configurator in M as indicated in the table below.

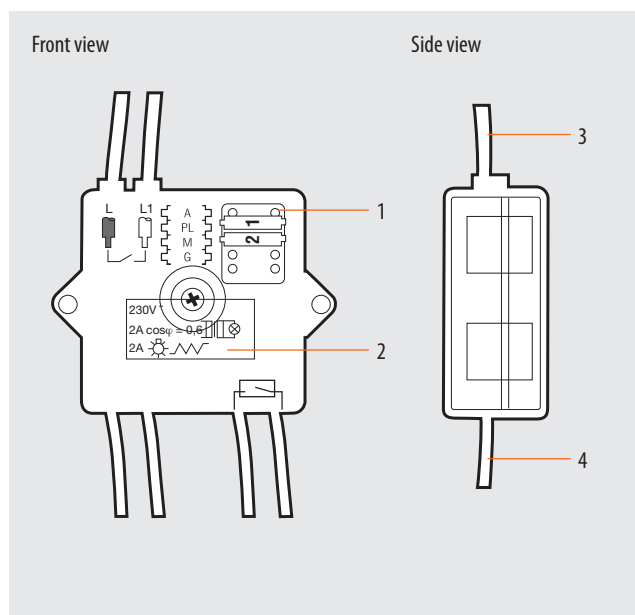

Legend

1. Configurator socket
2. LED
3. 0.75 mm² cords for connection to the load
4. BUS

Configurator	Time (minutes)
1	1
2	2
3	3
4	4
5	5
6	15
7	30 sec.
8	0.5 sec.